

FORM No. 1.

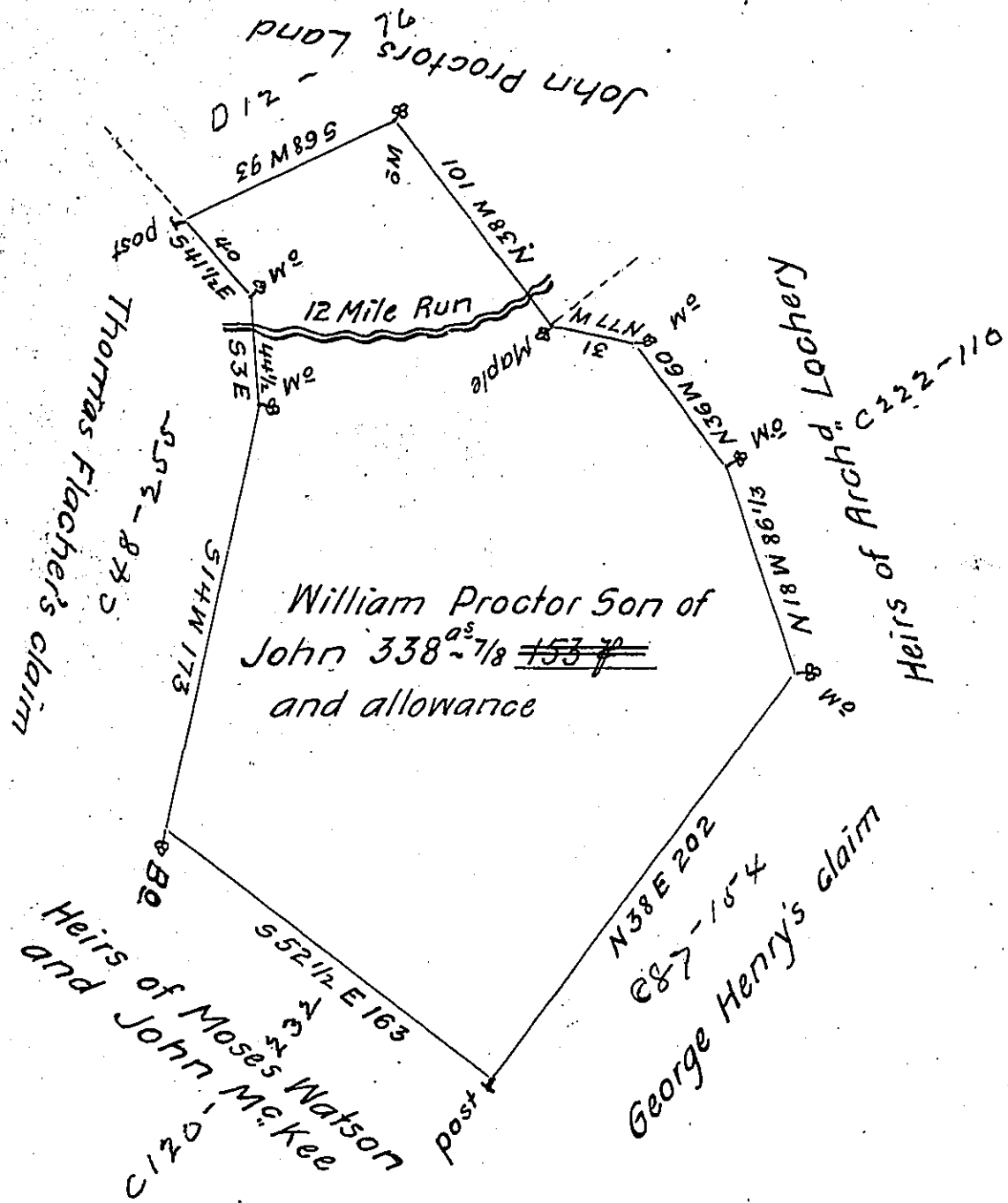

No 3432
 In pursuance of an Order dated June 13th 1769 was Survey'd for
 William Proctor Son of John the above described Tract of Land Con-
 taining Three Hundred and Thirty eight Acres and 153 7/8 Perches with
 an allowance proportioned to Six 7/8 Cent Situate on the Twelve Mile Run
 adjoining Land of Goll: John Proctor and others In Mt. pleasant Town-
 ship Westmorland County Survey'd Nov. 5th 1788 ~

John Moore D.S.

To John Lukens Esq. Surveyor Gen.

IN TESTIMONY that the above is a copy of the original remaining on file in
 the Department of Internal Affairs of Pennsylvania, made
 conformably to an Act of Assembly approved the 16th day of
 February, 1833, I have hereunto set my Hand and caused
 the Seal of said Department to be affixed at Harrisburg,
 this thirty-first day of January 1906

Loose P. Brown
 Secretary of Internal Affairs.